

SEAT COVER

INSTALLATION INSTRUCTION

Hinges

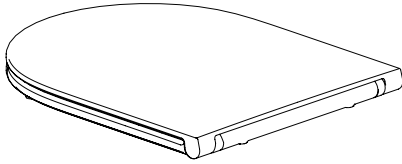

Fittings

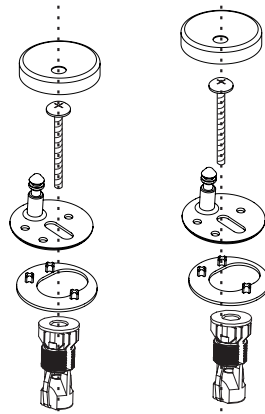

PULCHER®

INSTALLATION STEPS

- I Before installation, please check all spare parts are ready and match.
- All the above fittings are workable for installation, takes material object as the standard.

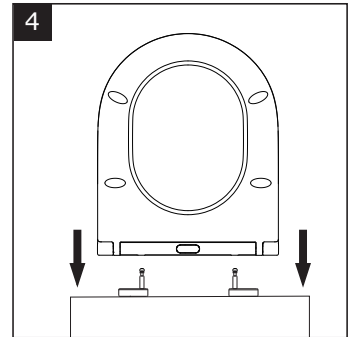
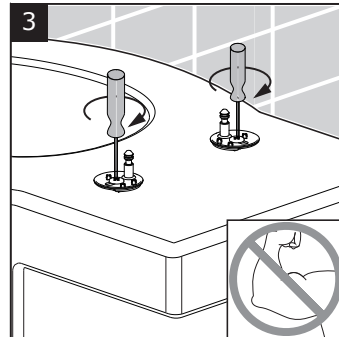
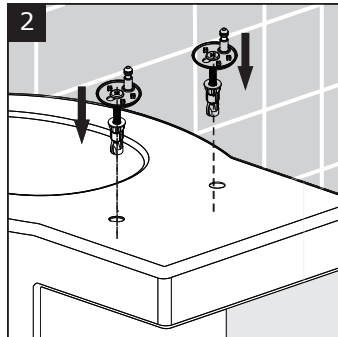
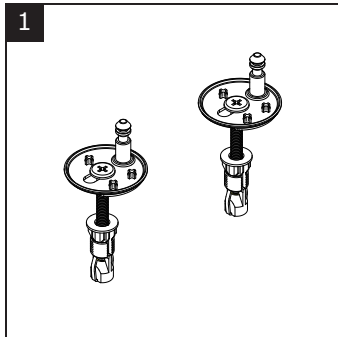

- 4 Before attaching the seat, move mounting bases so posts align with holes in the back of the seat. Once aligned, carefully lower the seat (holes) onto the mounting post.

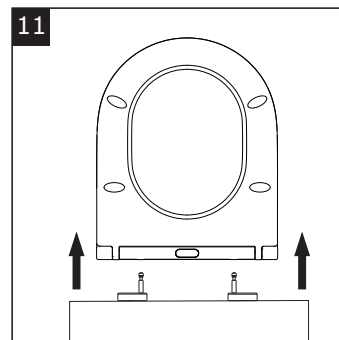
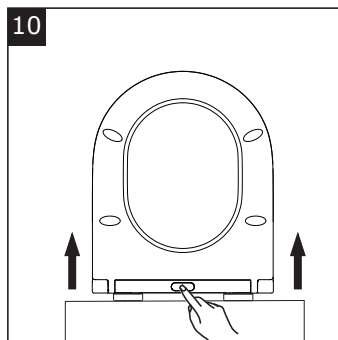
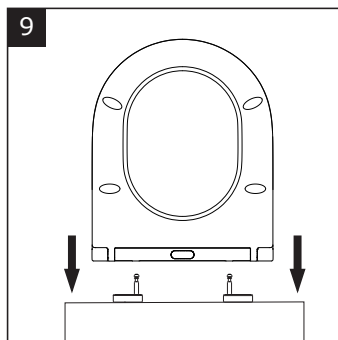
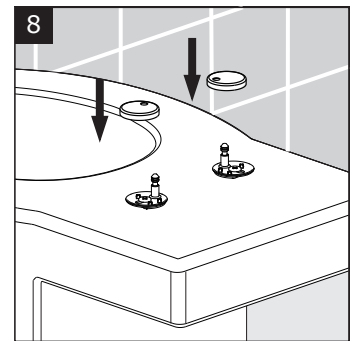
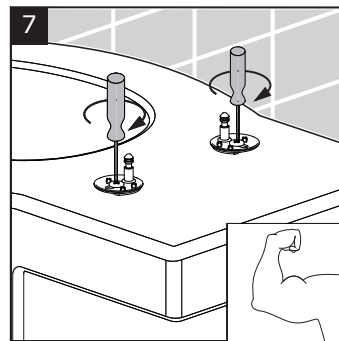
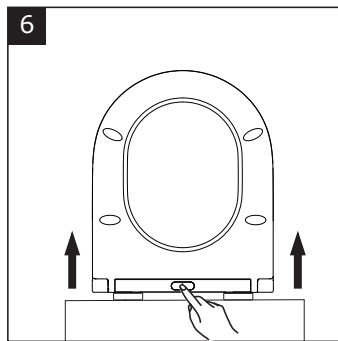
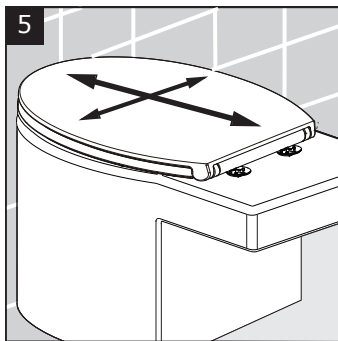

- 9 When mounting the seat make sure the posts align with holes in the back of seat. And carefully lower seat back into place ("click" will heard). Note: Do not push hard or force seat onto posts. (if difficult, re-check alignment.)
- 11 To remove the seat, press the quick - release button (should hear a "dick") and open seat to vertical position, then lift the seat straight up with one hand.

INSTRUCTIONS FOR THE USER

Do not force closure of the seat or lid, allow mechanism to close naturally.

MAINTENANCES AND CAUTIONS



Attention: Be careful the damage of toilet seat. Don't stand on the toilet seat,overloading may lead to toilet seat crushing or hinges broken.

Regular maintenance

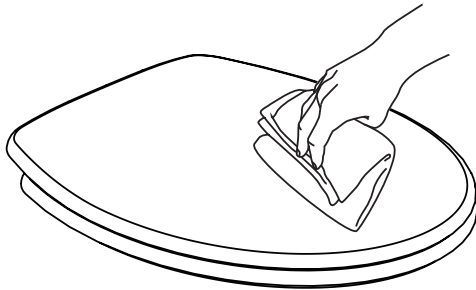

- Please clean the toilet seat with mild cleanser (such as soap water) and warm water,then dry it with clean soft cloth.
- Don't use the high-concentration detergent to clean, which may scratch the surface of the toilet seat and make the toilet seat tarnish.
- Please immediately wipe dry any foam on the surface of plastic toilet seat or electroplating cover.

Detergent

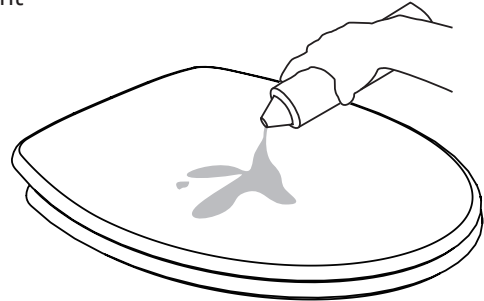

- Don't clean the toilet seat with abrasive powder.
- Avoid using any disinfectant,detergent or any other spraying cleanser
- Keep the toilet seat away from chemicals and cosmetics in bathroom.

CAUTIONS



- Please do not expose the toilet seat directly to the sunlight for along time. Avoid any strong lights and high temperature.

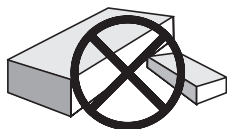

- Please do not put heavy things on the seat cover or suddenly sit forcefully on the seat, which may lead to the toilet seat crack.

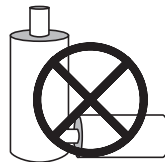

- Please do not clean the toilet seat with strong chemical cleanser or stiff brush.

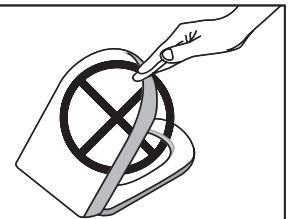

- Please do not close the seat or cover forcibly, which may lead to soft close function lose efficacy, affect your normal using.

* Please keep the products you buy to avoid improper storage (such as loss of accessories, etc.) affect the use of various functions of seat & cover.