

## SAFETY REGULATIONS



Goggles are recommended to protect your eyes.



We recommend that two persons are present at the installation.



Use safety shoes during installation.



Note! Always set the mirror down on a soft foundation, since edges and corners are very delicate.



May only be installed by certified electrician. Always shut off power to the circuit before starting installation work.

## IP-Zones

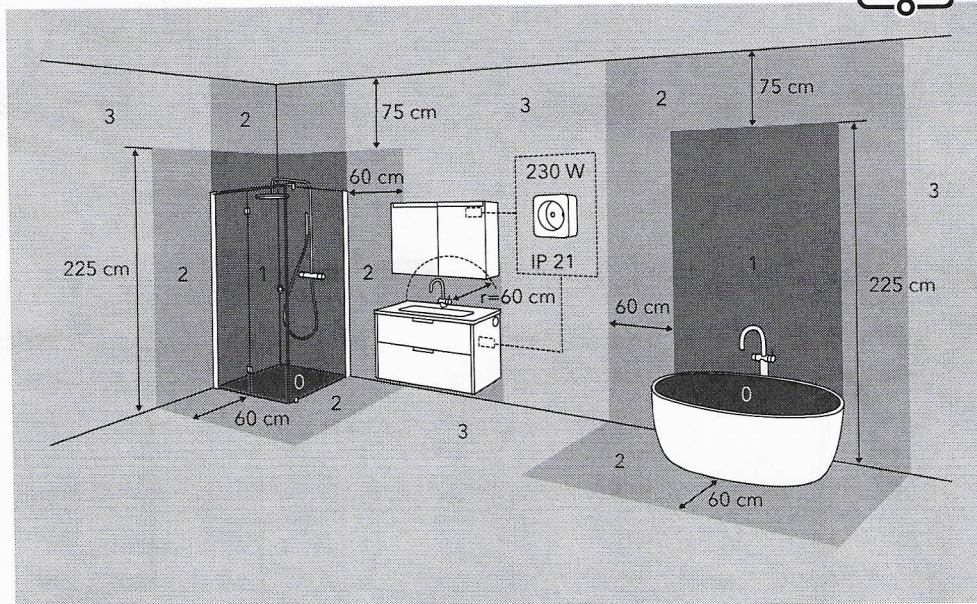

## TOOLS NEEDED

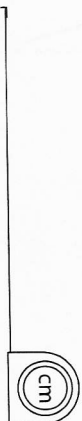
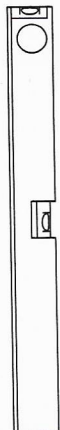

Pz 2



Ø8 mm

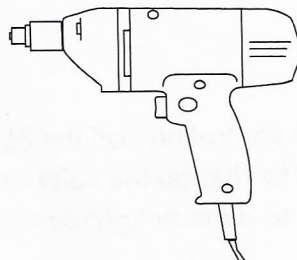

## Mounting Hardware Bag

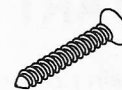

2x



2x

# INSTALLATION

1

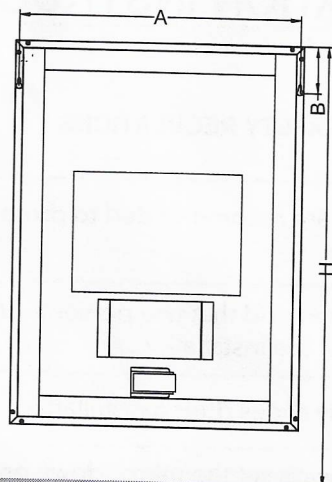

2

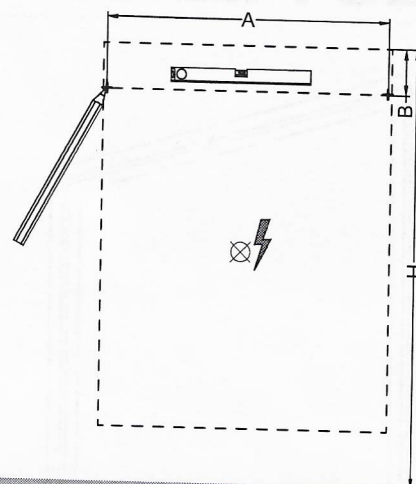

3

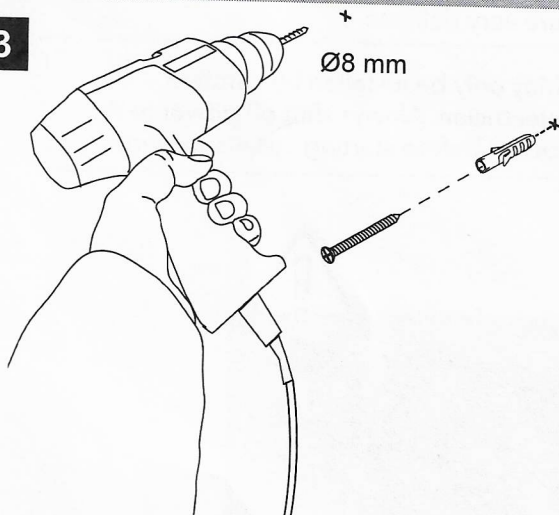

4

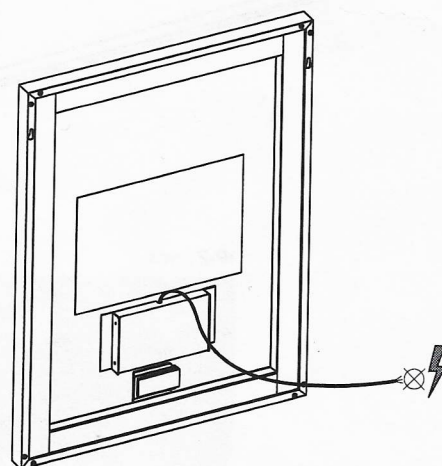

5

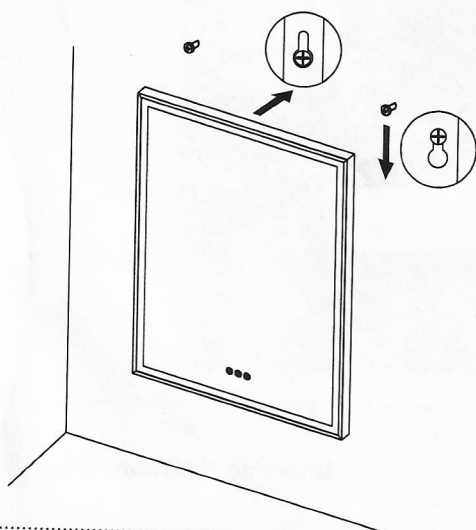



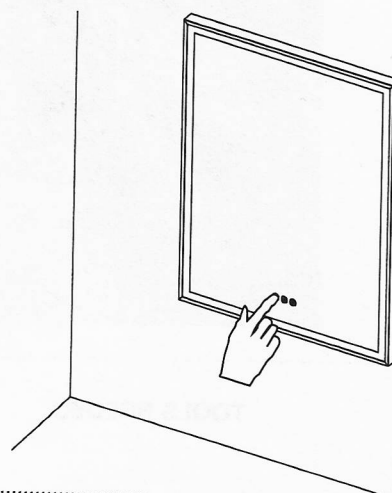

6

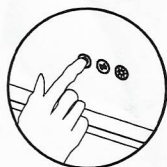

## MIRROR START UP

1. Connect to the main power.
  2. On/off button turns on.
- Now the system is ready to use.



Press the icon  shortly to control on / off the lighting and heating pad.  
Press and hold the icon  to change the colour temperature.  
Press and hold the icon  to dimmer light density.

The mirror remember your last position  
In case of problems, reset the mirror by turn the main power off .



# INSTALLATION

1

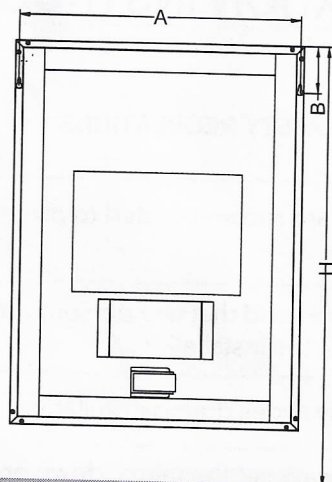

2

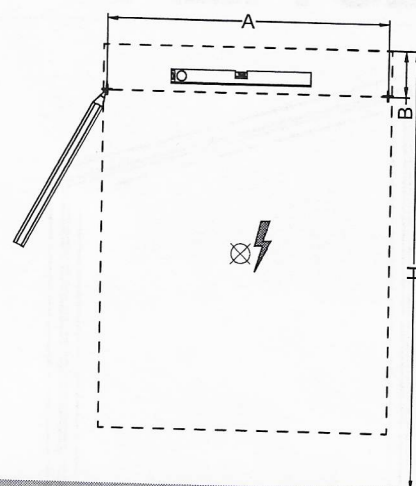

3

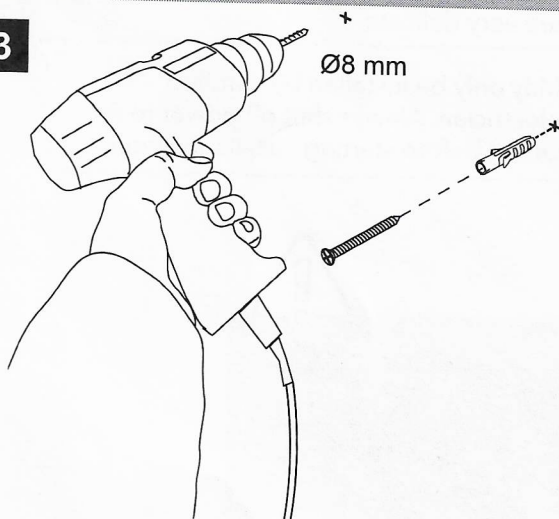

4

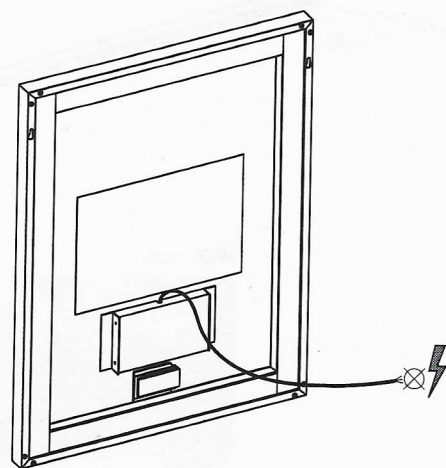

5

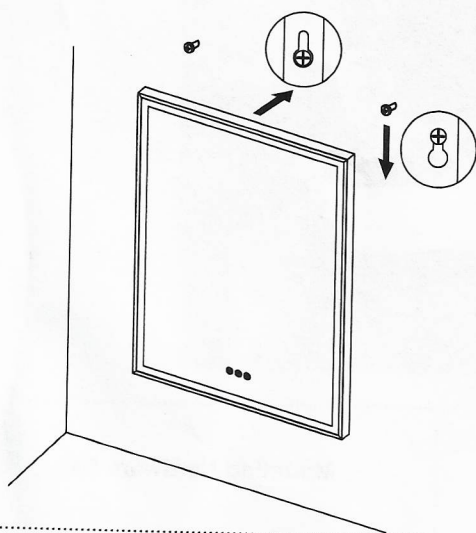



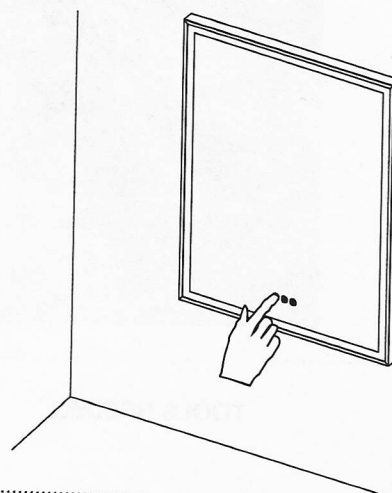

6

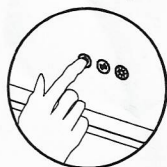

## MIRROR START UP

1. Connect to the main power.
  2. On/off button turns on.
- Now the system is ready to use.



Press the icon  shortly to control on / off the lighting and heating pad.  
Press and hold the icon  to change the colour temperature.  
Press and hold the icon  to dimmer light density.

The mirror remember your last position  
In case of problems, reset the mirror by turn the main power off .